



ZERO+ QUICK MILK

MEDIUM TO LOW VOLUME SUPER AUTOMATIC ESPRESSO MACHINE WITH QUICK MILK FRIDGE



ESPRESSO MACHINE SPECIFICATIONS

Versatile and multifunctional, Egro ZERO+ accommodates up to 16 different high-quality espresso beverages. The EGRO ZERO+ Quick Milk is equipped with an easy-to-use keypad interface. This medium-to-low volume super automatic espresso machine is perfect for adding espresso to any restaurant's breakfast or dinner menu, hotel VIP lounge, lobby and catering programs. It grinds, tamps, brews, and extracts fresh authentic espresso on-demand. The water for the Americano is delivered separately, before or after the espresso is brewed, and does not run through the brew chamber, producing authentic Americano at the push of a button. Dual grinders from Ditting™ and an 18-gram brew chamber enable this machine to deliver the best espresso of any super automatic in its class. Milk is delivered from a side refrigerator which holds up to 1 gallon of milk. The ZERO+ adds a volumetric pump to ensure that even extra-large drinks can be prepared quickly. This unit is the perfect addition to any independent or chain restaurant, hotel, or resort where quality and consistency is important and daily drink volumes are expected to be less than 100 cups a day.

MULTIFUNCTIONAL BACKLIT USER INTERFACE



ESPRESSO MACHINE STANDARD FEATURES

- Automatic milk frothing and delivery with a push of a button
- Quick Milk 1-gallon countertop fridge with top or side access holes for milk delivery hoses. Milk is siphoned directly from the milk container.
- Centralized hot water outlet with different temperature options
- Americano bypass enables machine to deliver authentic Americanos into a single cup
- Multifunctional and intuitive user interface with backlit keypad that enables up to 16 high-quality drink products
- Stainless steel 18-gram patented advanced brewing technology
- New volumetric pump enables all extra-large coffee drinks to be prepared quickly and is not dependant on main water supply pressure
- Dual grinders by Ditting™
- Made of painted steel and ABS plastic
- Easy step-by-step automatic daily cleaning program
- LED illuminated work area
- Powder inlet for pre-ground regular and decaf coffee
- USB port makes it easy to save drink parameters and make software and programming updates
- Single component two-piece dispensing outlet for easy cleaning
- Power-efficient 110 V
- 2-year parts warranty

ESPRESSO MACHINE OPTIONS

Tank Version: Self-contained water reservoir and drain reservoir; not available with new volumetric pump

Manual Steam Wand: For milk frothing

Under Counter Grounds Chute: chute that diverts ground coffee to under the counter waste container; not available when an under the counter fridge is installed directly under the machine

External Hot Water Outlet: Hot water delivered through a separate outlet to the right of the drink spout

Locks Package: Locks for hopper, grounds drawer, and fridge

Powder Module: Enables machine to deliver up to two types of powder; for example, chocolate for mochas and hot chocolate

ESPRESSO MACHINE STANDARD ACCESSORIES

- Plastic grounds bin container
- One month supply of daily cleaning products
- Milk container
- Container for daily cleaning
- User manual
- Foot extensions

ESPRESSO MACHINE DATA SPECIFICATIONS

- Weight: 99 lbs (machine) 30 lbs (fridge)
- Power Supply: 110 - 120 V (machine) 110 V (fridge)
- Power Rating: 1800 W (machine) 86 W (fridge)
- Tank Version: 4.5 Liters (1.19 gallons)



ZERO+ QUICK MILK

MEDIUM TO LOW VOLUME SUPER AUTOMATIC ESPRESSO MACHINE WITH QUICK MILK FRIDGE

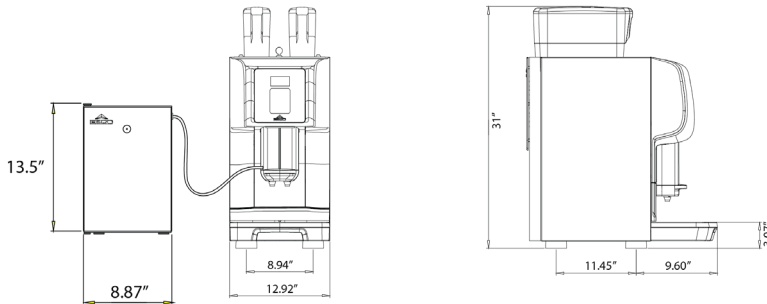

TOTAL COUNTER-TOP REQUIREMENTS

Width: 22" Depth: 24" Height: 31" Weight: 130 lbs

SHIPPING DIMENSIONS AND WEIGHT

Length: 36" Width: 36" Height: 33" Weight: 183 lbs

COUNTER TOP HOLE PLAN

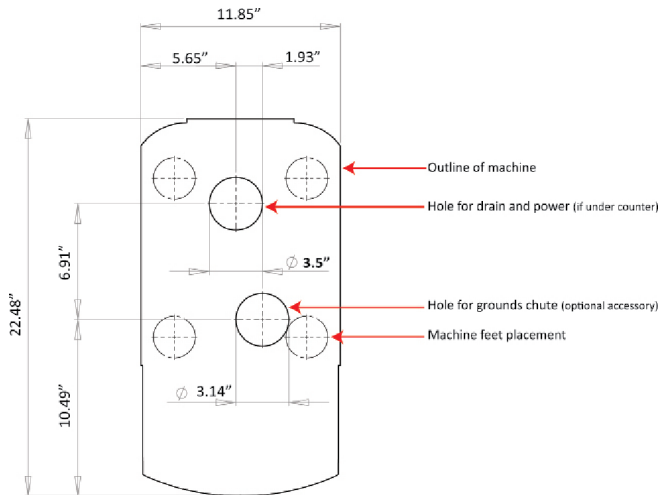

QUICK MILK FRIDGE SPECIFICATIONS

The Quick Milk Fridge is a unit with smaller dimensions and with great aesthetic impact. Its housing is made from lightweight yet hardwearing materials, the stainless steel door has a brushed finish, and its storage capacity holds 1 gallon of milk.



SPACE REQUIREMENTS

Allow 1.5" of clearance on all sides of the machine.
 Allow space to fill bean hoppers from the top:
 4" minimum - 12" preferred.
 Allow 24" x 5" of space for in-line filter. Filter can be mounted behind the machine or under the counter.

SERVICE CONNECTIONS

ELECTRICAL CONNECTIONS:

Espresso Machine

Voltage Range: 110 - 120 V

Watts: 1800

Circuit Size: 15 Amps

Suggested Receptacle: 5-20R

Suggested Receptacle for Espresso Machine

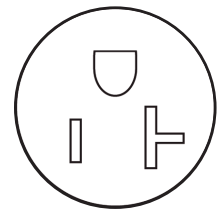

5-20R

Quick Milk Fridge

Voltage: 110 V

Watts: 86

Circuit Size: 15 Amps

Suggested Receptacle: 5-15R GFI

PLEASE NOTE: Power can be installed under or above the counter. Please allow 3.5" - 4" of space for the plug, especially when placing power above the counter and behind the machine.

WATER CONNECTION:

Dedicated cold water access line with standard female 3/8" NPT fitting and manual shut-off valve within 4' of the machine.

DRAIN REQUIREMENTS:

Open gravity drain with minimum 2" I.D. within 4' of the machine.

WATER QUALITY STATEMENT:

The fact that water is potable is no guarantee that it is suitable for espresso machines. Your water supply must be within these general guidelines:

SUPPLY PRESSURE: 30-70 psi

HARDNESS: 2-3 GPG*

*17.1 ppm = 1 grain of hardness

Water entering the machine should have a water hardness level of 2-3 GPG at all times. If the water supply is not within this range, a dedicated water softener (if above 3 GPG) or mineral addition cartridge (if below 2 GPG) is required for the espresso machine to operate properly over time (see Rancilio Group North America water quality statement for further details).